

Clearing a Paper Misfeed

■ Locating a paper misfeed

The equipment stops copying when the original or copy paper is misfed. Paper misfeeds are notified on the touch panel as follows:

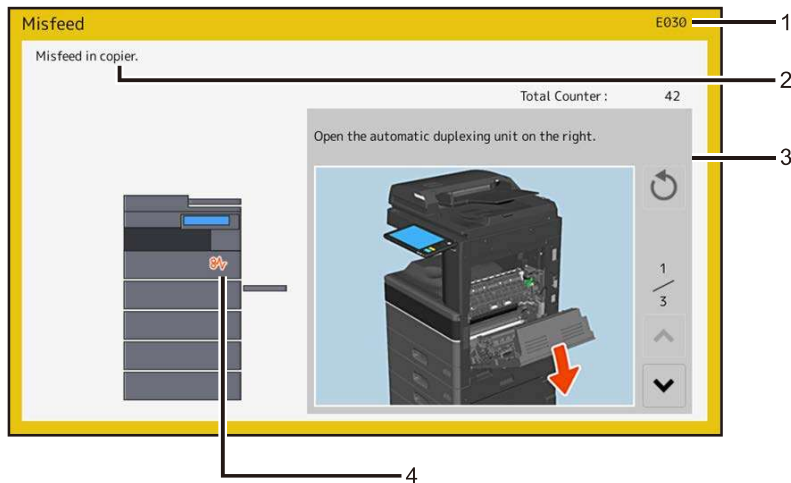

1. Error code
2. Error message
3. Guidance for clearing paper misfeeds
4. Paper misfeed symbols

The paper misfeed symbol helps you locate the paper misfeed.

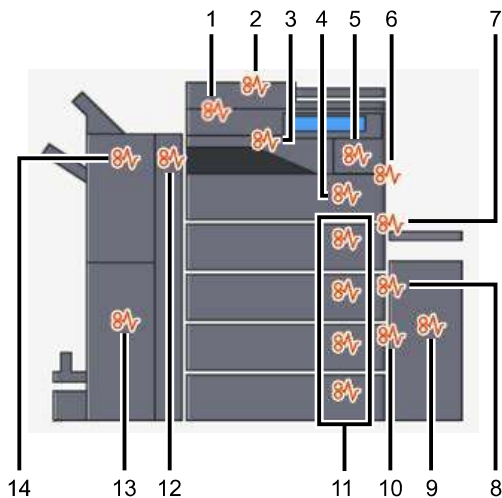



1. RADF or DSDF (lower) (📖 P.16)
2. RADF or DSDF (upper) (📖 P.17)
3. Job Separator, Offset Tray (📖 P.36) or Bridge Kit (📖 P.37)
4. Paper transport path (📖 P.33)
5. Fuser unit (📖 P.34)
6. Automatic duplexing unit (📖 P.32)
7. Bypass tray (📖 P.31)
8. Drawer feeding portion (📖 P.23)
9. External Large Capacity Feeder (2000 sheets) (📖 P.22)
10. Large Capacity Feeder (📖 P.25) or Paper Feed Pedestal (📖 P.26)
11. Drawers (📖 P.27, 📖 P.28), Envelope Drawer (📖 P.29) or drawer of the Large Capacity Feeder (📖 P.30)
12. Hole Punch Unit (📖 P.38, 📖 P.43, 📖 P.53)
13. Saddle stitch unit (📖 P.47)
14. Finisher (📖 P.38, 📖 P.43, 📖 P.53)

The picture of the hardware device shown on the touch panel differs depending on the options installed.

■ Clearing a paper misfeed

1 Clear the paper misfeed.

Clear the paper misfeed following the guidance shown on the touch panel. Press  or  to scroll the pages. You can play an animation from the beginning by pressing .

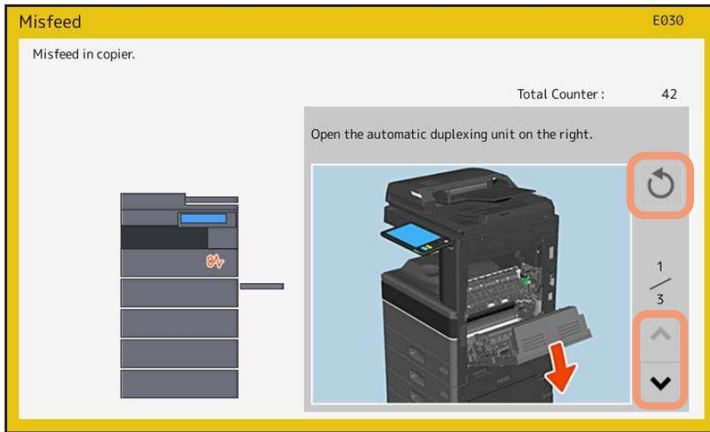

2 After clearing the misfeed, close all the opened covers.

The equipment starts the warm-up. Follow the guidance on the touch panel.

□ Tips on removing the misfed paper

Note the following points in removing the misfed paper.

Remove the misfed paper carefully so as not to tear it.

To avoid tearing the misfed paper, remove the paper slowly with both hands. Using force may tear the paper, making it more difficult to remove. See also that no pieces of torn paper are left inside the equipment.

When the paper misfeed sign remains after removing the misfed paper:

Depending on the timing of the occurrence, no misfed paper may be found where the paper misfeed sign indicates. If the sign does not disappear after you have removed the misfed paper, follow the steps as instructed on the touch panel.

Do not touch the connectors and harnesses inside the equipment.

This could cause a malfunction.

Do not touch the fuser unit or the metal portion around it.

⚠ CAUTION

Do not touch the fuser unit or the metal portion around it when you remove the paper misfed in the right side of the equipment. This could burn you or the shock could cause you to get your hand injured in the machine.

